

✓

York County Shore

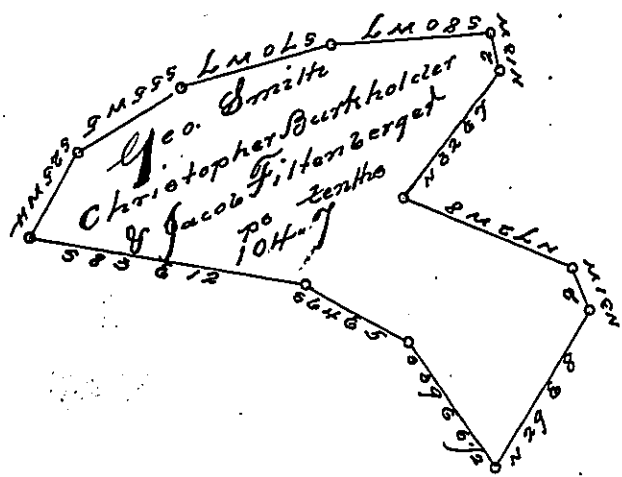

Lancaster County Shore

A Draught of Beach Island situated in Drumore Township Lancaster County opposite Land of Thomas Neill on the Lancaster side & opposite to land of Wm. Meyers on the York County side lying East of Little Chesnut Island about ten perches North east from Big Chesnut Island about fifteen perches above Hares Island. Containing One hundred & four perches & seven tenths strict measure. Surveyed in pursuance of a Warrant dated the 7th day of September A.D. 1818 granted to George Smith, Christopher Burkholder & Jacob Filzenberg.

Pr. Jacob Heiskman Df.

To Jacob Spangler Esq.
 Surveyor General

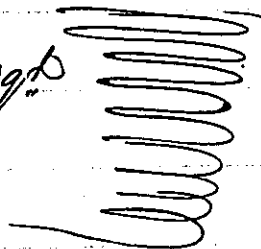

red

IN TESTIMONY that the above is a copy of the original remaining on file in the Department of Internal Affairs of Pennsylvania, made conformably to an Act of Assembly approved the 16th day of February, 1833, I have hereunto set my Hand and caused the Seal of said Department to be affixed at Harrisburg, this fourth day of July 1899

James W. Pitts
 Secretary of Internal Affairs.